

V:\gis\projects\16112-BT-1A-HUT-S3-DR-CU-27031\_Proposed\_Diversions\_ESB.dwg

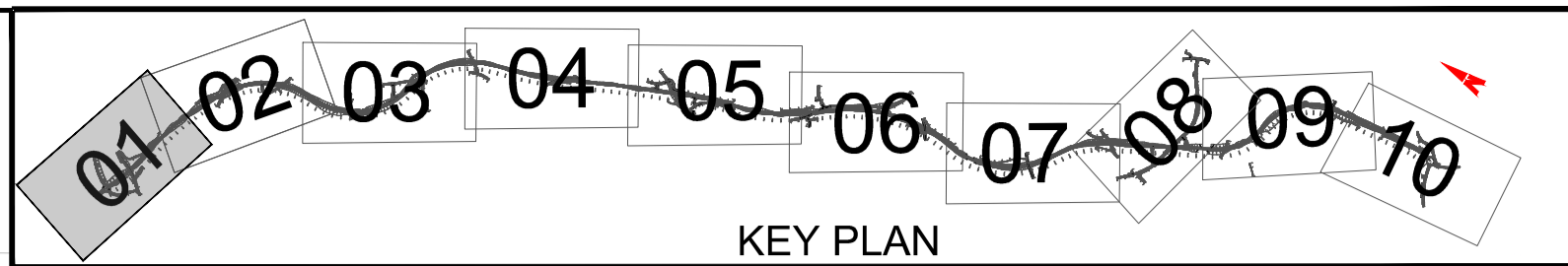

**LEGEND:**

PROPOSED DEVELOPMENT		PROPOSED ESB POLE - 38kV & BELOW	
PROPOSED DEVELOPMENT BOUNDARY		PROPOSED UNDERGROUND DIVERSION - 38kV & BELOW	
EXISTING OVERHEAD ESB LINE 110kV		PROPOSED OVERGROUND DIVERSION - 38kV & BELOW	
EXISTING OVERHEAD ESB LINE 38kV		PROPOSED 110kV (HV) ESB POLE SET	
EXISTING OVERHEAD ESB LINE MV		CONFLICTS IDENTIFIED	
EXISTING UNDERGROUND ESB CABLE MV		EXISTING REGIONAL/LOCAL ROAD NAMES	
EXISTING OVERHEAD ESB LINE LV		EXISTING NATIONAL ROAD NAMES	
EXISTING UNDERGROUND ESB CABLE LV			

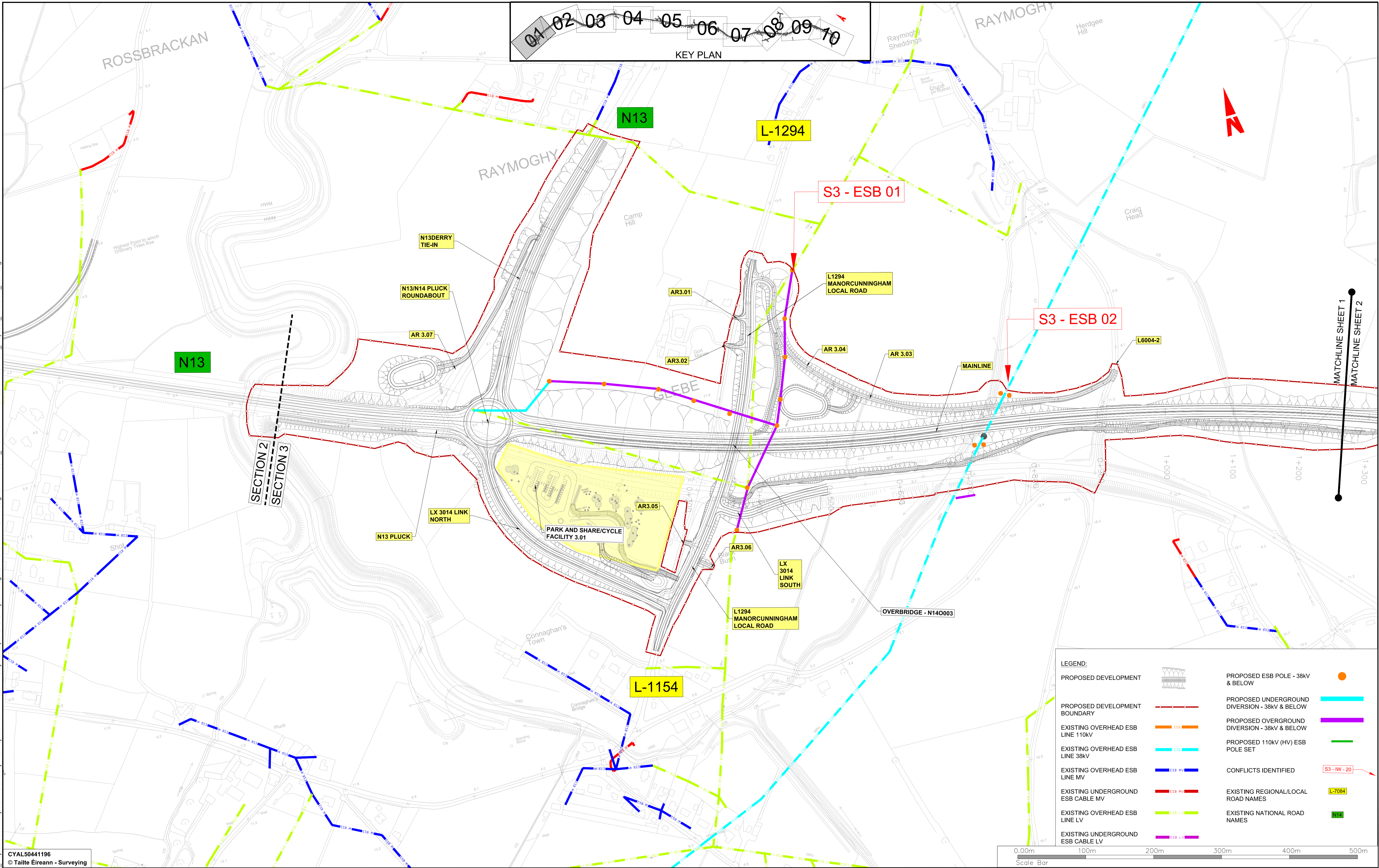
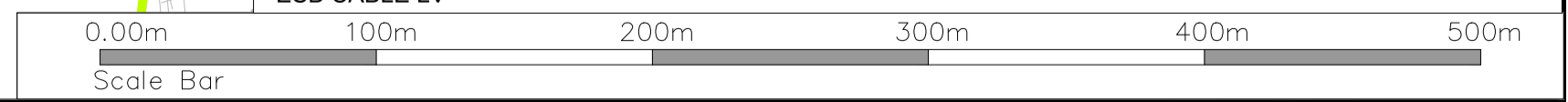

CYAL50441196  
© Taite Éireann - Surveying



**Notes**  
DO NOT SCALE. Use figured dimensions only. All levels are referred to Ordnance Survey Datum, Main Head.  
This drawing is the property of Donegal County Council. It is a confidential document and must not be copied, used, or its contents divulged without prior written consent. This document should not be relied on or used in circumstances other than those for which it was originally prepared. Barry Transportation accepts no responsibility for this document to any other party other than the party by whom it was commissioned.

Rev.	Date	Drawn	Description	Chk'd	Appr.
P01	13.11.25	MG	ISSUE FOR PLANNING	JMM	ED

Project Title: TEN-T PRIORITY ROUTE IMPROVEMENT PROJECT DONEGAL Section 3 - N14 Manor Cunningham to Lifford/Strabane/A5 Link		Status: A3	
Drawing Title: Proposed Diversion ESB		Rev: P01	
Designed: JMM	Date: NOV 2025	EIAR Drawing Identifier:	
Drawn: MG	Scale @ A1: 1:2500 @ A3: 1:5000	EIAR Drawing 16.09	
Approved: ED	Sheet: Sheet 1 of 10	File Identifier:	TT_Y16112-BT-1A-HUT-S3-DR-CU-27031
Checked: JMM			

**LEGEND:**

PROPOSED DEVELOPMENT		PROPOSED ESB POLE - 38kV & BELOW	
PROPOSED DEVELOPMENT BOUNDARY		PROPOSED UNDERGROUND DIVERSION - 38kV & BELOW	
EXISTING OVERHEAD ESB LINE 110kV		PROPOSED OVERGROUND DIVERSION - 38kV & BELOW	
EXISTING OVERHEAD ESB LINE 38kV		PROPOSED 110kV (HV) ESB POLE SET	
EXISTING OVERHEAD ESB LINE MV		CONFLICTS IDENTIFIED	
EXISTING UNDERGROUND ESB CABLE MV		EXISTING REGIONAL/LOCAL ROAD NAMES	
EXISTING OVERHEAD ESB LINE LV		EXISTING NATIONAL ROAD NAMES	
EXISTING UNDERGROUND ESB CABLE LV			

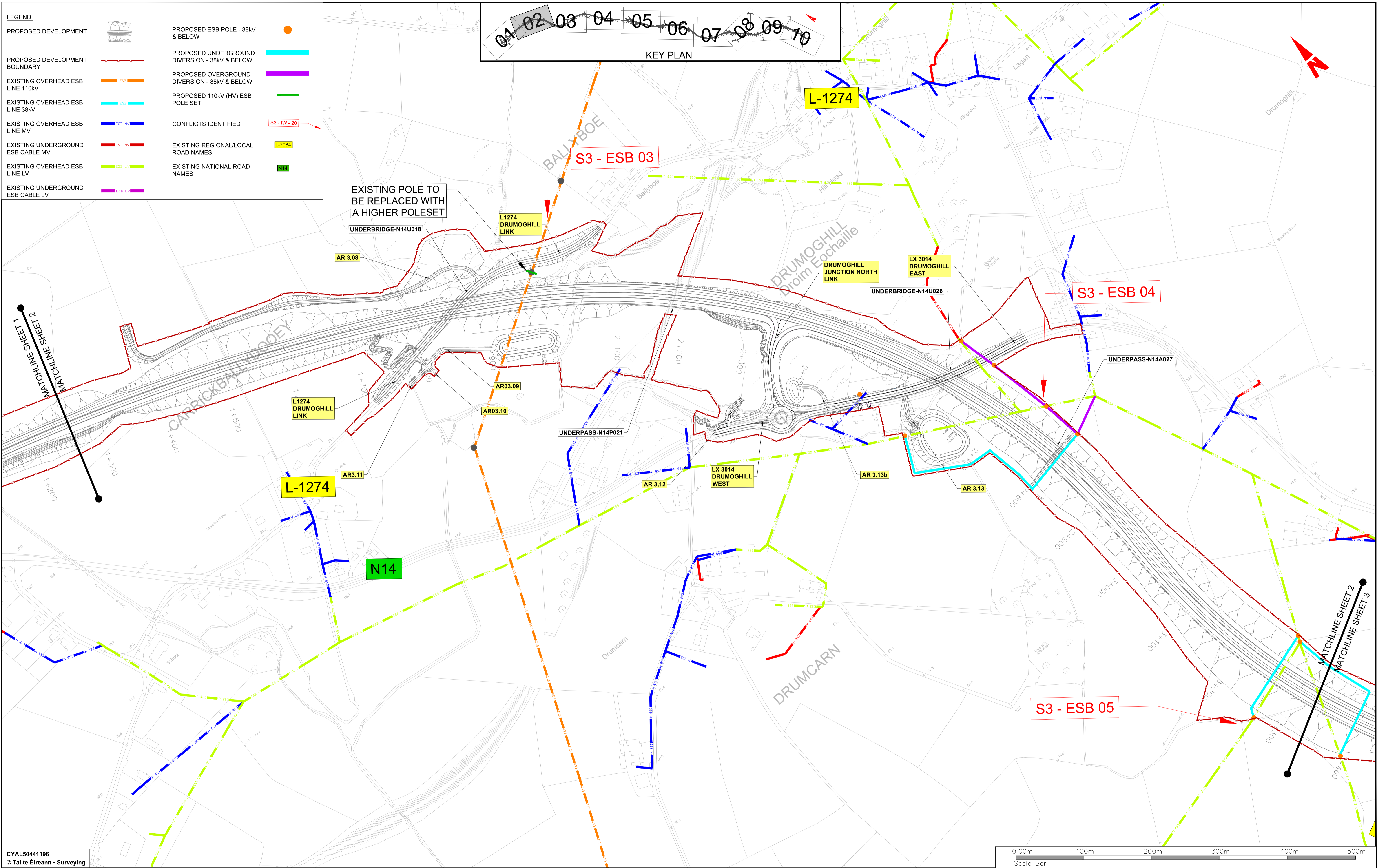
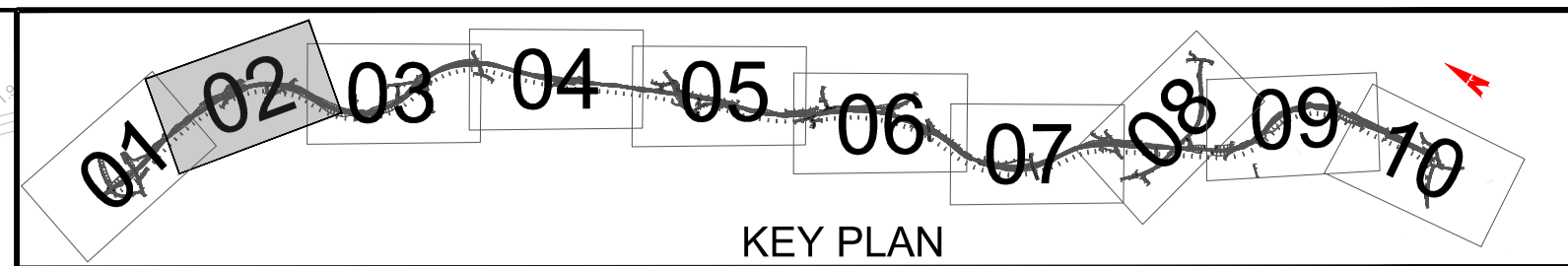

CYAL50441196  
© Taitte Éireann - Surveying

Notes  
DO NOT SCALE, use figured dimensions only. All levels are referred to Ordnance Survey Datum, Mean Head.  
This drawing is the property of Donegal County Council. It is a confidential document and must not be copied, used, or its contents divulged without prior written consent. This document should not be relied on or used in circumstances other than those for which it was originally prepared. Barry Transportation accepts no responsibility for this document to any other party other than the party by whom it was commissioned.

Rev.	Date	Drawn	Description	Chk'd	Appr.
P01	13.11.25	MG	ISSUE FOR PLANNING	JMM	ED

Project Title: TEN-T PRIORITY ROUTE IMPROVEMENT PROJECT DONEGAL  
Section 3 - N14 Manorcunningham to Lifford/Strabane/A5 Link

Drawing Title: Proposed Diversion ESB

Status: A3

Designed: JMM Date: NOV 2025 EIA Drawing Identifier:  
Drawn: MG Scale @ A1: 1:2500 EIA Drawing 16.09  
Approved: ED @ A3: 1:5000 File Identifier:  
Checked: JMM Sheet: 2 OF 10 TT\_Y16112-BT-1A-HUT-S3-DR-CU-27031

Rev: P01

V:\gis\ra\local\bu\_mens\UBB\0 - Projects\Donegal\Projects\Halcrow\Barry\16 Projects\Y16112-BT-1A-HUT-S3-DR-CU-27031\_Proposed\_Diversions\_ESB.dwg

**LEGEND:**

PROPOSED DEVELOPMENT		PROPOSED ESB POLE - 38kV & BELOW	
PROPOSED DEVELOPMENT BOUNDARY		PROPOSED UNDERGROUND DIVERSION - 38kV & BELOW	
EXISTING OVERHEAD ESB LINE 110kV		PROPOSED OVERGROUND DIVERSION - 38kV & BELOW	
EXISTING OVERHEAD ESB LINE 38kV		PROPOSED 110kV (HV) ESB POLE SET	
EXISTING OVERHEAD ESB LINE MV		CONFLICTS IDENTIFIED	
EXISTING UNDERGROUND ESB CABLE MV		EXISTING REGIONAL/LOCAL ROAD NAMES	
EXISTING OVERHEAD ESB LINE LV		EXISTING NATIONAL ROAD NAMES	
EXISTING UNDERGROUND ESB CABLE LV			

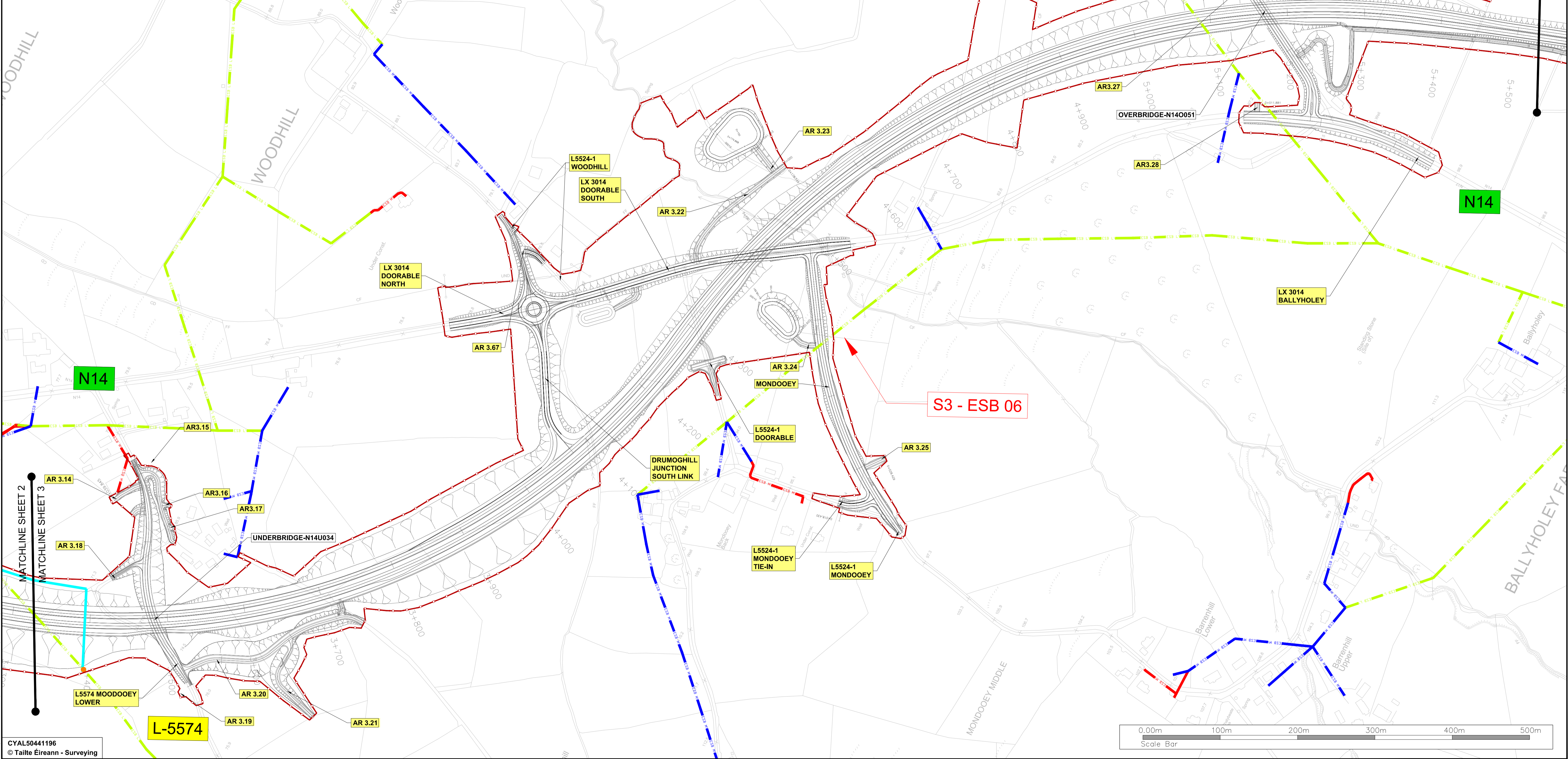
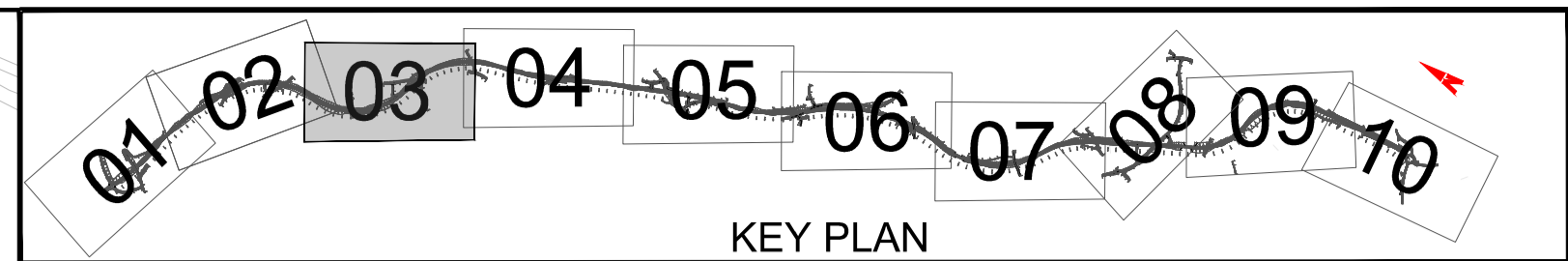

\legis.racine.local\bu\_mens\UBS\0 - Projects\Dublin\Projects\Halcrow\Barr\16 - TEN-T Priority Route Improvement Project Donegal\Civil-CAD\WIP\Preim Design\CIV\DWG\Gst\TT\_Y16112-BT-1A-HUT-S3-DR-CU-27031 - Proposed\_Diversions\_ESB.dwg

CYAL50441196  
© Taite Éireann - Surveying



**Notes**  
 DO NOT SCALE. Use figured dimensions only. All levels are referred to Ordnance Survey Datum, Mean Sea Level.  
 This drawing is the property of Donegal County Council. It is a confidential document and must not be copied, used, or its contents divulged without prior written consent. This document should not be relied on or used in circumstances other than those for which it was originally prepared. Barry Transportation accepts no responsibility for this document to any other party other than the party by whom it was commissioned.

Rev.	Date	Drawn	Description	Chk'd	Appr.
P01	13.11.25	MG	ISSUE FOR PLANNING	JMM	ED

Project Title: TEN-T PRIORITY ROUTE IMPROVEMENT PROJECT DONEGAL		Section 3 - N14 Manorunningham to Lifford/Strabane/A5 Link	
Drawing Title: Proposed Diversion ESB		Status: A3	
Designed: JMM	Date: NOV 2025	EIAR Drawing Identifier:	Rev: P01
Drawn: MG	Scale @ A1: 1:2500	EIAR Drawing 16.09	
Approved: ED	@ A3: 1:5000	File Identifier:	
Checked: JMM	Sheet: 3 OF 10	TT_Y16112-BT-1A-HUT-S3-DR-CU-27031	

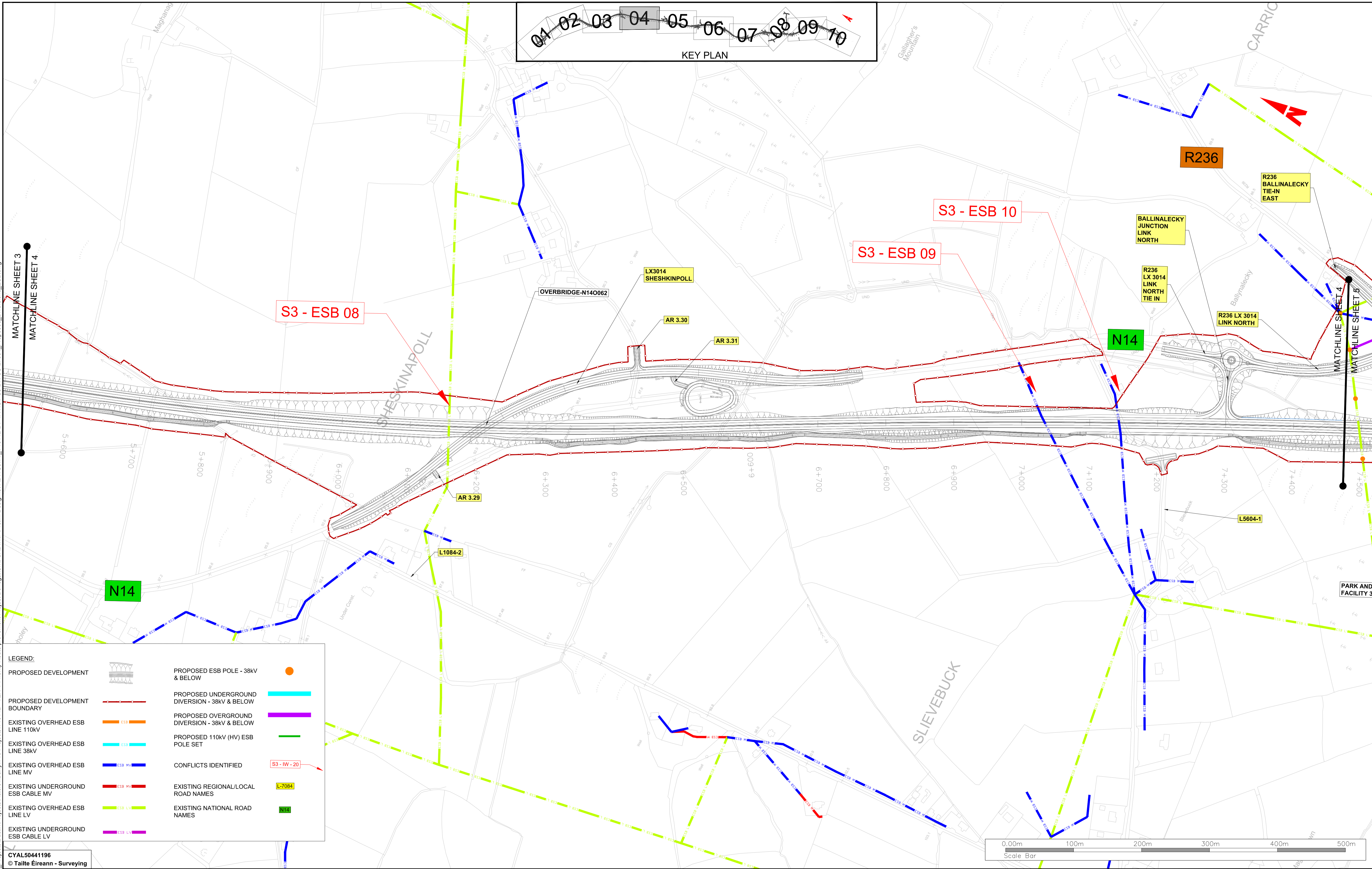
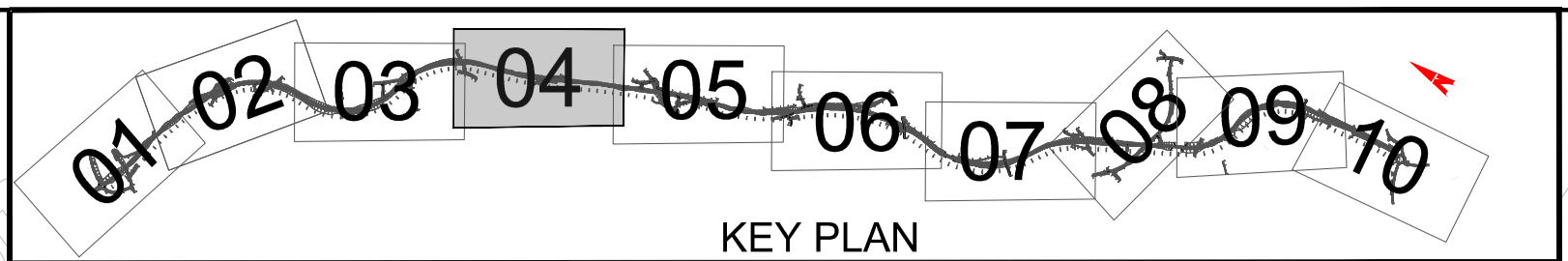

**LEGEND:**

PROPOSED DEVELOPMENT		PROPOSED ESB POLE - 38kV & BELOW	
PROPOSED DEVELOPMENT BOUNDARY		PROPOSED UNDERGROUND DIVERSION - 38kV & BELOW	
EXISTING OVERHEAD ESB LINE 110kV		PROPOSED OVERGROUND DIVERSION - 38kV & BELOW	
EXISTING OVERHEAD ESB LINE 38kV		PROPOSED 110kV (HV) ESB POLE SET	
EXISTING OVERHEAD ESB LINE MV		CONFLICTS IDENTIFIED	
EXISTING UNDERGROUND ESB CABLE MV		EXISTING REGIONAL/LOCAL ROAD NAMES	
EXISTING OVERHEAD ESB LINE LV		EXISTING NATIONAL ROAD NAMES	
EXISTING UNDERGROUND ESB CABLE LV			

CYAL50441196  
© Taite Éireann - Surveying

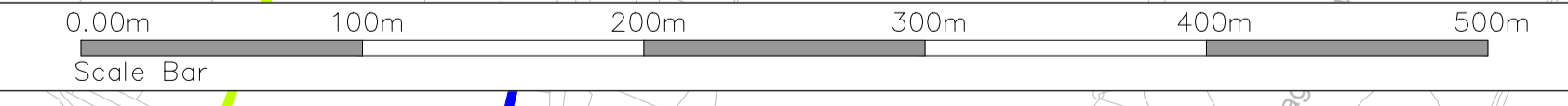

**Notes**  
DO NOT SCALE. Use figured dimensions only. All levels are referred to Ordnance Survey Datum, Mean Head.  
This drawing is the property of Donegal County Council. It is a confidential document and must not be copied, used, or its contents divulged without prior written consent. This document should not be relied on or used in circumstances other than those for which it was originally prepared. Barry Transportation accepts no responsibility for this document to any other party other than the party by whom it was commissioned.

Rev.	Date	Drawn	Description	Chk'd	Appr.
P01	13.11.25	MG	ISSUE FOR PLANNING	JMM	ED

Project Title: TEN-T PRIORITY ROUTE IMPROVEMENT PROJECT DONEGAL Section 3 - N14 Manorcunningham to Lifford/Strabane/A5 Link		Drawing Title: Proposed Diversion ESB		Status: A3
Designed: JMM	Date: NOV 2025	EIAR Drawing Identifier:		Rev: P01
Drawn: MG	Scale @ A1: 1:2500	EIAR Drawing 16.09		
Approved: ED	@ A3: 1:5000	File Identifier:		
Checked: JMM	Sheet: 4 OF 10	TT_Y16112-BT-1A-HUT-S3-DR-CU-27031		

V:\gis\racine\local\mens\UBB\0 - Projects\Y16112 - TEN-T Priority Route Improvement Project Donegal\Civil-CAD\WIP\PreIm Design\CIV\DWG\GATTT\_Y16112-BT-1A-HUT-S3-DR-CU-27031\_Proposed\_Diversions\_ESB.dwg

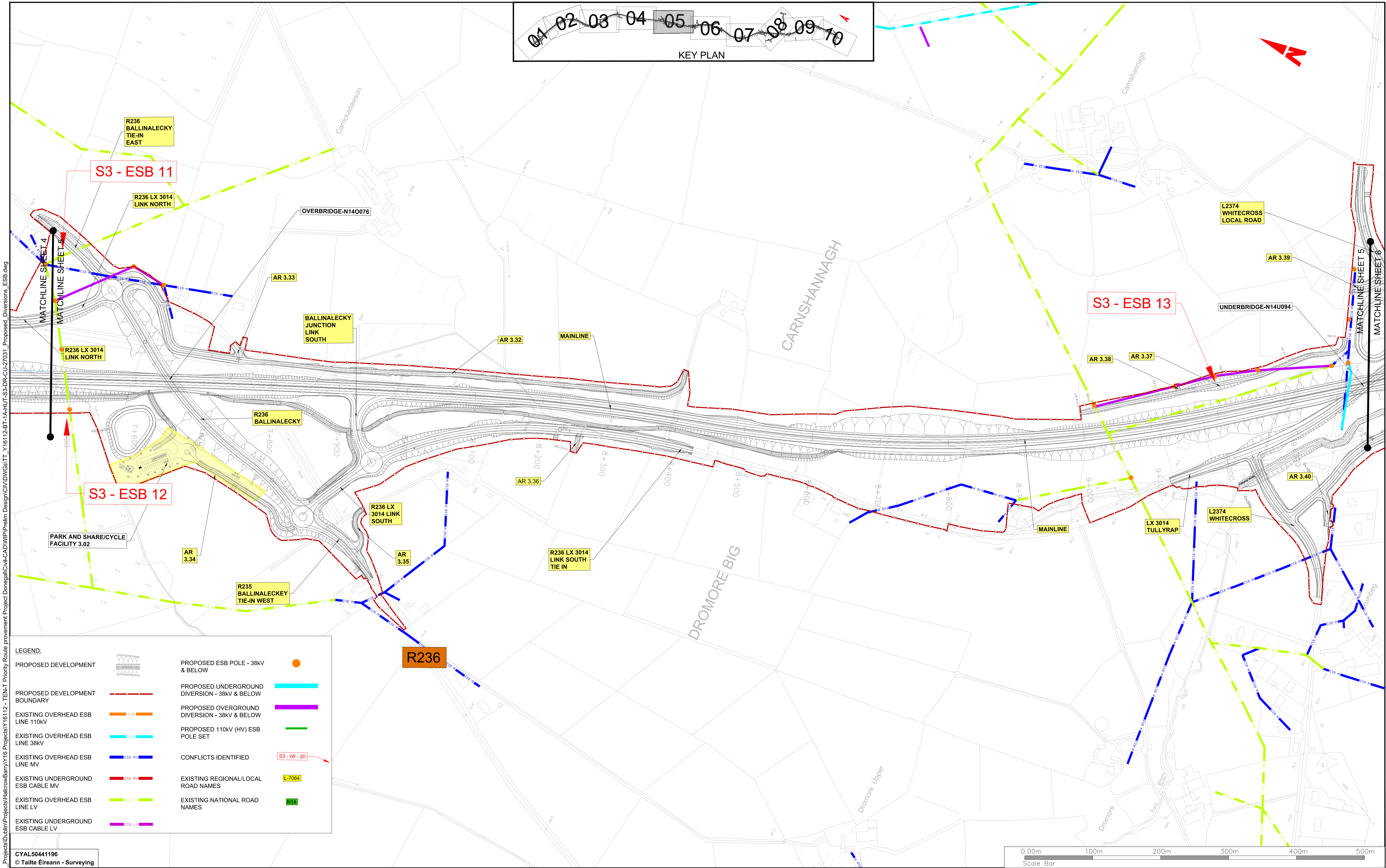
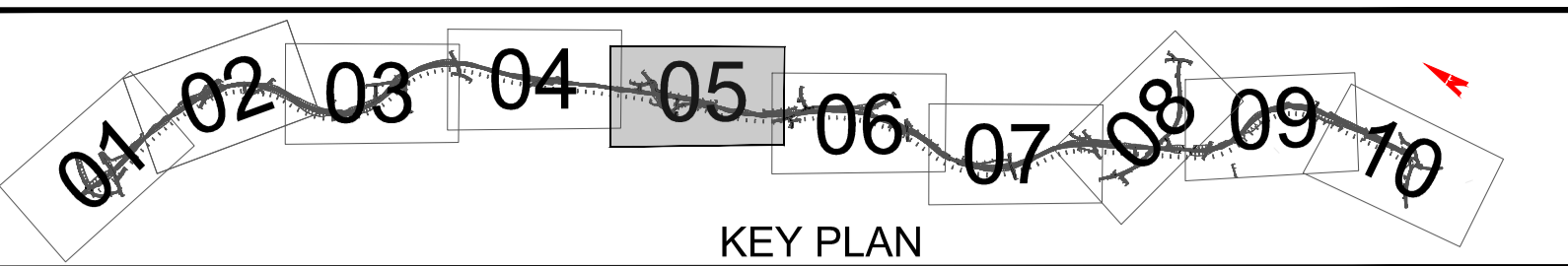

**LEGEND:**

PROPOSED DEVELOPMENT		PROPOSED ESB POLE - 38kV & BELOW	
PROPOSED DEVELOPMENT BOUNDARY		PROPOSED UNDERGROUND DIVERSION - 38kV & BELOW	
EXISTING OVERHEAD ESB LINE 110kV		PROPOSED OVERGROUND DIVERSION - 38kV & BELOW	
EXISTING OVERHEAD ESB LINE 38kV		PROPOSED 110kV (HV) ESB POLE SET	
EXISTING OVERHEAD ESB LINE MV		CONFLICTS IDENTIFIED	
EXISTING UNDERGROUND ESB CABLE MV		EXISTING REGIONAL/LOCAL ROAD NAMES	
EXISTING OVERHEAD ESB LINE LV		EXISTING NATIONAL ROAD NAMES	
EXISTING UNDERGROUND ESB CABLE LV			

CYAL50441196  
© Taite Éireann - Surveying



**Notes**  
DO NOT SCALE. Use figured dimensions only. All levels are referred to Ordnance Survey Datum, Main Head.  
This drawing is the property of Donegal County Council. It is a confidential document and must not be copied, used, or its contents divulged without prior written consent. This document should not be relied on or used in circumstances other than those for which it was originally prepared. Barry Transportation accepts no responsibility for this document to any other party other than the party by whom it was commissioned.

Rev.	Date	Drawn	Description	Chk'd	Appr.
P01	13.11.25	MG	ISSUE FOR PLANNING	JMM	ED

Project Title: TEN-T PRIORITY ROUTE IMPROVEMENT PROJECT DONEGAL Section 3 - N14 Manorcunningham to Lifford/Strabane/A5 Link		Drawing Title: Proposed Diversion ESB		Status: A3
Designed: JMM	Date: NOV 2025	EIAR Drawing Identifier:		Rev: P01
Drawn: MG	Scale @ A1: 1:2500	EIAR Drawing 16.09		
Approved: ED	@ A3: 1:5000	File Identifier:	TT_Y16112-BT-1A-HUT-S3-DR-CU-27031	
Checked: JMM	Sheet: 5 OF 10			

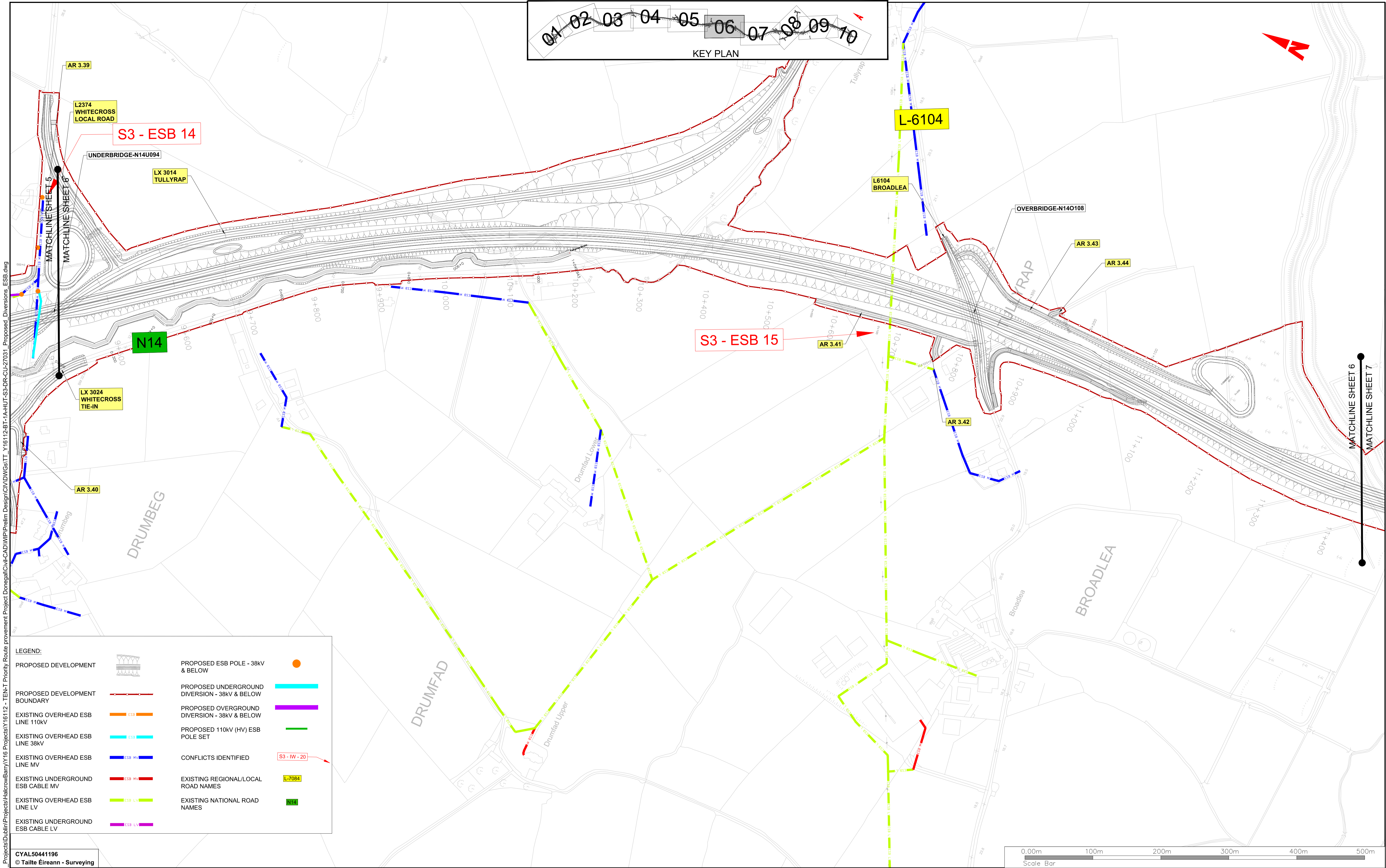
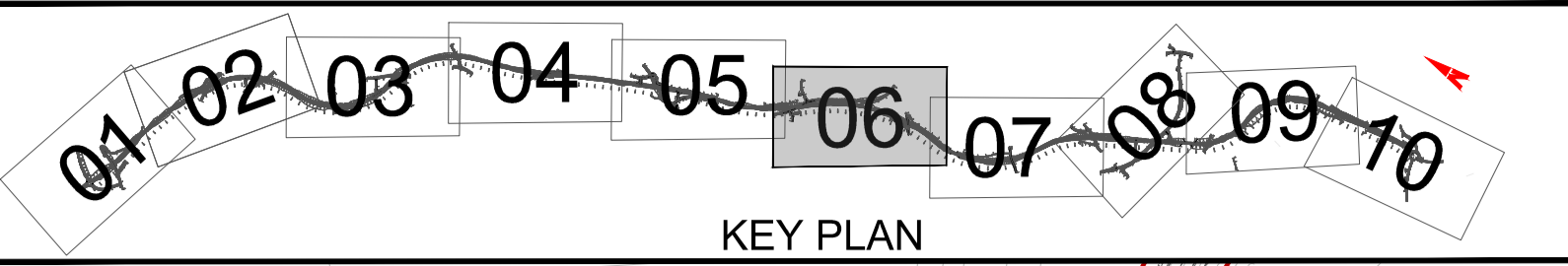

**LEGEND:**

PROPOSED DEVELOPMENT		PROPOSED ESB POLE - 38kV & BELOW	
PROPOSED DEVELOPMENT BOUNDARY		PROPOSED UNDERGROUND DIVERSION - 38kV & BELOW	
EXISTING OVERHEAD ESB LINE 110kV		PROPOSED OVERGROUND DIVERSION - 38kV & BELOW	
EXISTING OVERHEAD ESB LINE 38kV		PROPOSED 110kV (HV) ESB POLE SET	
EXISTING OVERHEAD ESB LINE MV		CONFLICTS IDENTIFIED	
EXISTING UNDERGROUND ESB CABLE MV		EXISTING REGIONAL/LOCAL ROAD NAMES	
EXISTING OVERHEAD ESB LINE LV		EXISTING NATIONAL ROAD NAMES	
EXISTING UNDERGROUND ESB CABLE LV			

CYAL50441196  
© Taite Éireann - Surveying

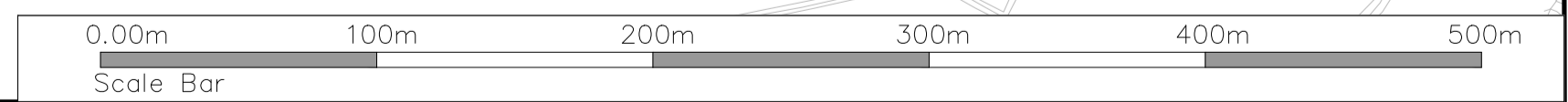

**Notes**  
DO NOT SCALE. Use figured dimensions only. All levels are referred to Ordnance Survey Datum, Mean Head.  
This drawing is the property of Donegal County Council. It is a confidential document and must not be copied, used, or its contents divulged without prior written consent. This document should not be relied on or used in circumstances other than those for which it was originally prepared. Barry Transportation accepts no responsibility for this document to any other party other than the party by whom it was commissioned.

Rev.	Date	Drawn	Description	Chk'd	Appr.
P01	13.11.25	MG	ISSUE FOR PLANNING	JMM	ED

Project Title: TEN-T PRIORITY ROUTE IMPROVEMENT PROJECT DONEGAL		Section 3 - N14 Manorunningham to Lifford/Strabane/A5 Link	
Drawing Title: Proposed Diversion ESB		Status: A3	
Designed: JMM	Date: NOV 2025	EAIR Drawing Identifier:	Rev: P01
Drawn: MG	Scale @ A1: 1:2500	EAIR Drawing 16.09	
Approved: ED	@ A3: 1:5000	File Identifier:	
Checked: JMM	Sheet: 6 OF 10	TT_Y16112-BT-1A-HUT-S3-DR-CU-27031	

**LEGEND:**

PROPOSED DEVELOPMENT		PROPOSED ESB POLE - 38kV & BELOW	
PROPOSED DEVELOPMENT BOUNDARY		PROPOSED UNDERGROUND DIVERSION - 38kV & BELOW	
EXISTING OVERHEAD ESB LINE 110kV		PROPOSED OVERGROUND DIVERSION - 38kV & BELOW	
EXISTING OVERHEAD ESB LINE 38kV		PROPOSED 110kV (HV) ESB POLE SET	
EXISTING OVERHEAD ESB LINE MV		CONFLICTS IDENTIFIED	
EXISTING UNDERGROUND ESB CABLE MV		EXISTING REGIONAL/LOCAL ROAD NAMES	
EXISTING OVERHEAD ESB LINE LV		EXISTING NATIONAL ROAD NAMES	
EXISTING UNDERGROUND ESB CABLE LV			

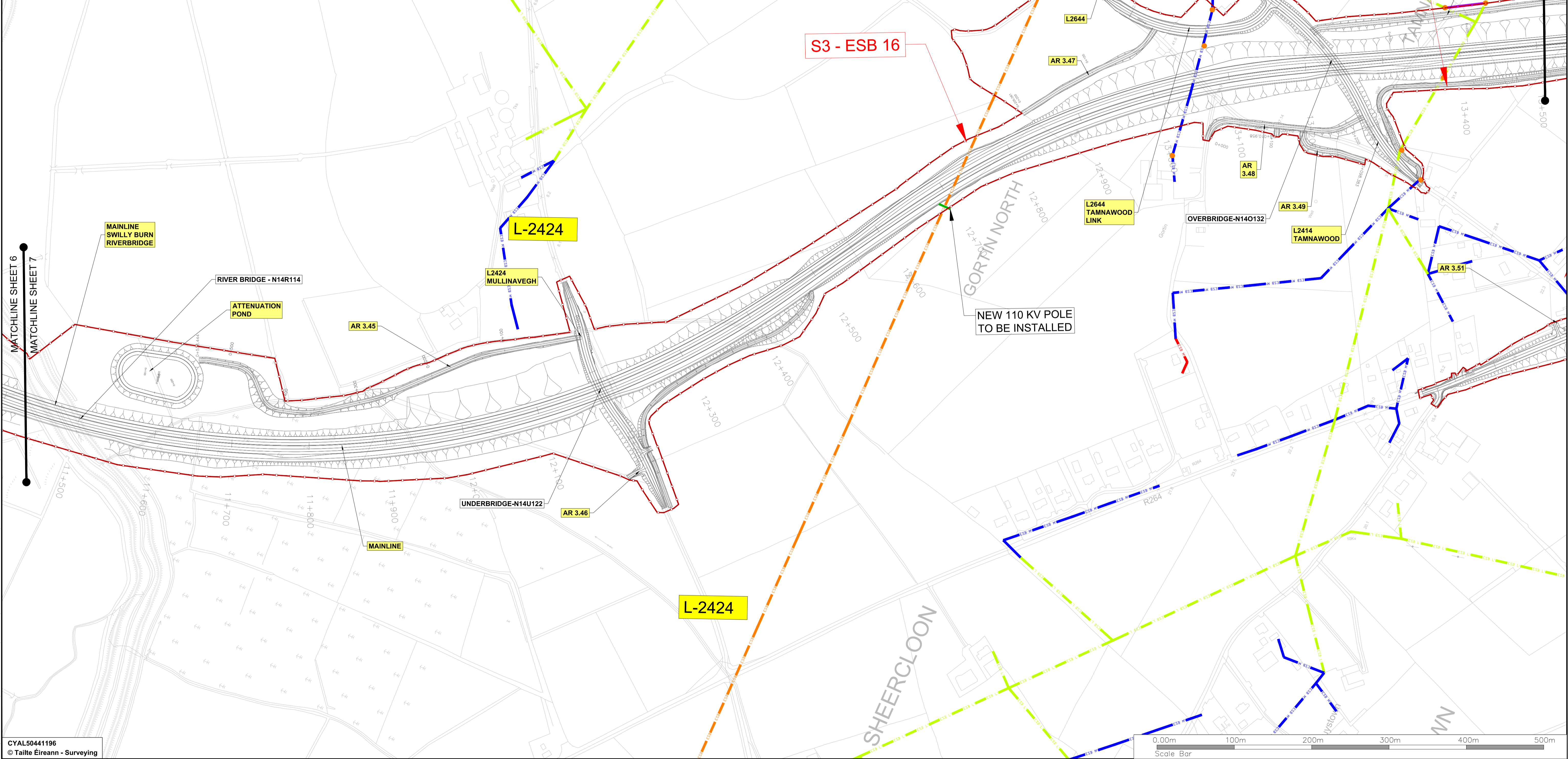
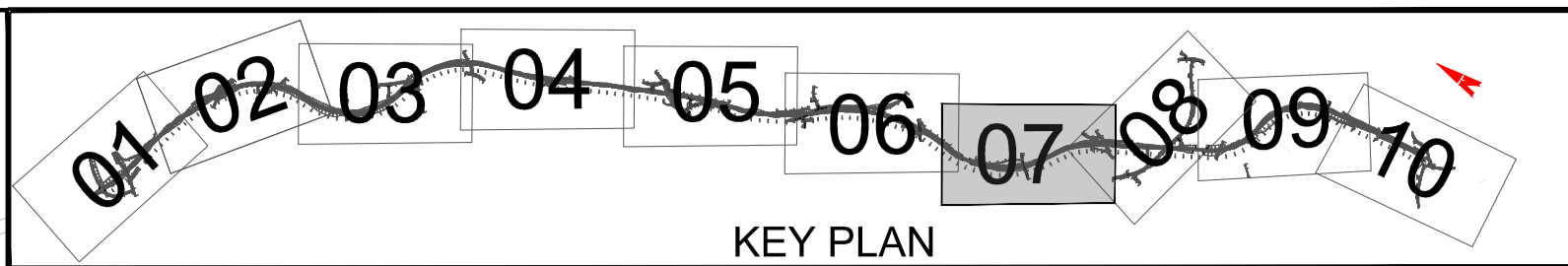

CYAL50441196  
© Taite Éireann - Surveying



**Notes**  
DO NOT SCALE. Use figured dimensions only. All levels are referred to Ordnance Survey Datum, Mean Head.  
This drawing is the property of Donegal County Council. It is a confidential document and must not be copied, used, or its contents divulged without prior written consent. This document should not be relied on or used in circumstances other than those for which it was originally prepared. Barry Transportation accepts no responsibility for this document to any other party other than the party by whom it was commissioned.

Rev.	Date	Drawn	Description	Chk'd	Appr.
P01	13.11.25	MG	ISSUE FOR PLANNING	JMM	ED

**Project Title:** TEN-T PRIORITY ROUTE IMPROVEMENT PROJECT DONEGAL  
Section 3 - N14 Manorcunningham to Lifford/Strabane/A5 Link

**Drawing Title:** Proposed Diversion ESB

**Status:** A3

**Designed:** JMM **Date:** NOV 2025 **EIAR Drawing Identifier:**

**Drawn:** MG **Scale @ A1:** 1:2500 **EIAR Drawing:** 16.09

**Approved:** ED **@ A3:** 1:5000 **File Identifier:** TT\_Y16112-BT-1A-HUT-S3-DR-CU-27031

**Checked:** JMM **Sheet:** 7 OF 10

V:\gis\racine\localbu\_mens\UBS\0 - Projects\Donegal\Projects\Halcrow\Barry\16 Projects\Y16112-BT-1A-HUT-S3-DR-CU-27031\_Proposed\_Diversions\_ESB.dwg

**LEGEND:**

PROPOSED DEVELOPMENT		PROPOSED ESB POLE - 38kV & BELOW	
PROPOSED DEVELOPMENT BOUNDARY		PROPOSED UNDERGROUND DIVERSION - 38kV & BELOW	
EXISTING OVERHEAD ESB LINE 110kV		PROPOSED OVERGROUND DIVERSION - 38kV & BELOW	
EXISTING OVERHEAD ESB LINE 38kV		PROPOSED 110kV (HV) ESB POLE SET	
EXISTING OVERHEAD ESB LINE MV		CONFLICTS IDENTIFIED	
EXISTING UNDERGROUND ESB CABLE MV		EXISTING REGIONAL/LOCAL ROAD NAMES	
EXISTING OVERHEAD ESB LINE LV		EXISTING NATIONAL ROAD NAMES	
EXISTING UNDERGROUND ESB CABLE LV			

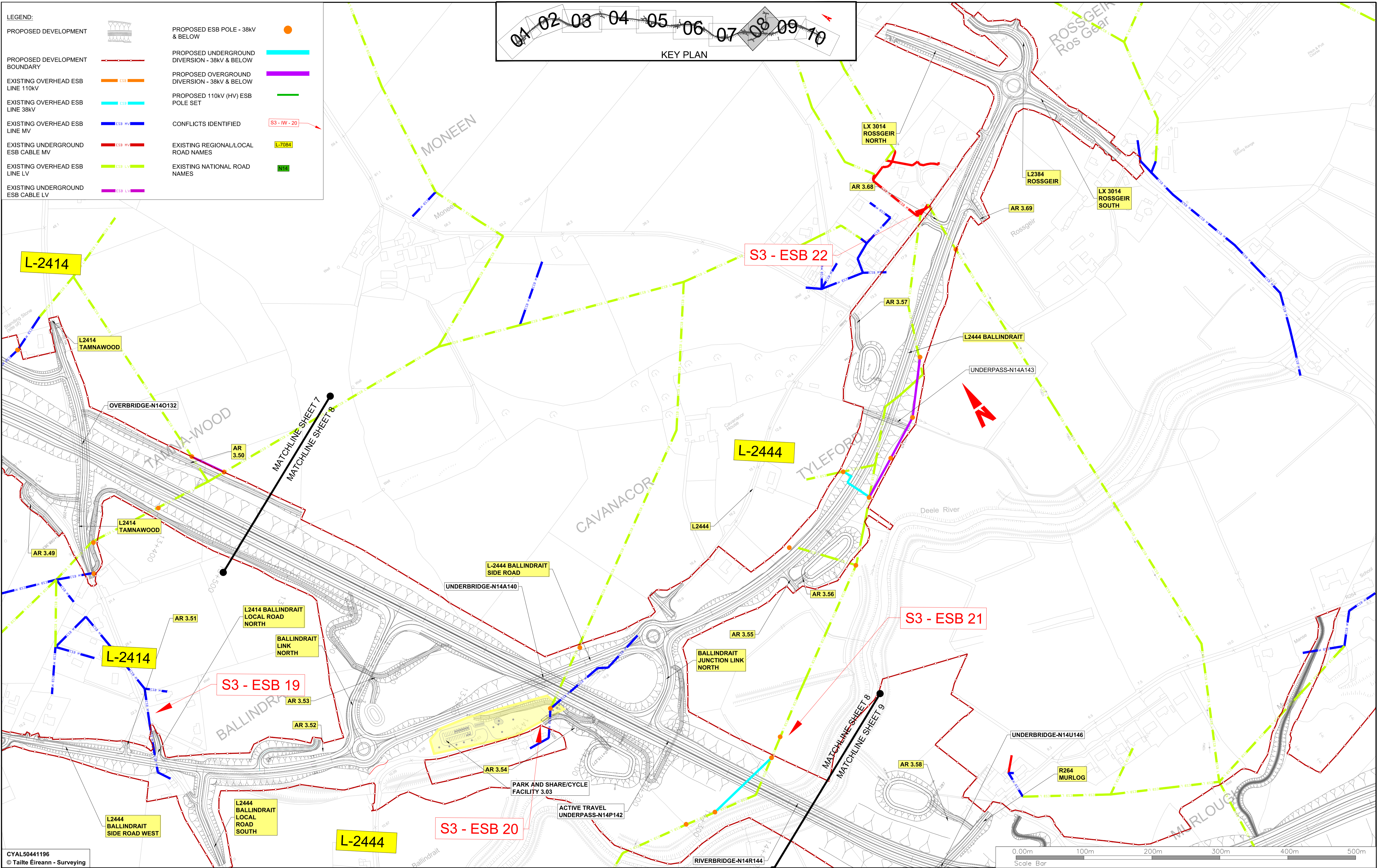
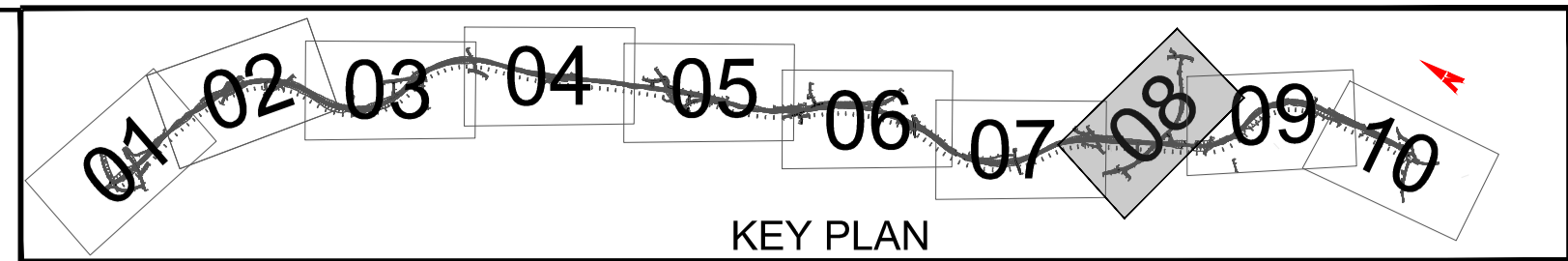

CYAL50441196  
© Taite Éireann - Surveying



Notes  
DO NOT SCALE. Use figured dimensions only. All levels are referred to Ordnance Survey Datum, Mean Head.  
This drawing is the property of Donegal County Council. It is a confidential document and must not be copied, used, or its contents divulged without prior written consent. This document should not be relied on or used in circumstances other than those for which it was originally prepared. Barry Transportation accepts no responsibility for this document to any other party other than the party by whom it was commissioned.

Rev.	Date	Drawn	Description	Chk'd	Appr.
P01	13.11.25	MG	ISSUE FOR PLANNING	JMM	ED

Project Title: TEN-T PRIORITY ROUTE IMPROVEMENT PROJECT DONEGAL Section 3 - N14 Manorunningham to Lifford/Strabane/A5 Link		Drawing Title: Proposed Diversion ESB		Status: A3
Designed: JMM	Date: NOV 2025	EIAR Drawing Identifier:		Rev: P01
Drawn: MG	Scale @ A1: 1:2500 @ A3: 1:5000	EIAR Drawing Identifier:	EIAR Drawing 16.09	
Approved: ED	Sheet: 8 OF 10	File Identifier:	TT_Y16112-BT-1A-HUT-S3-DR-CU-27031	
Checked: JMM				

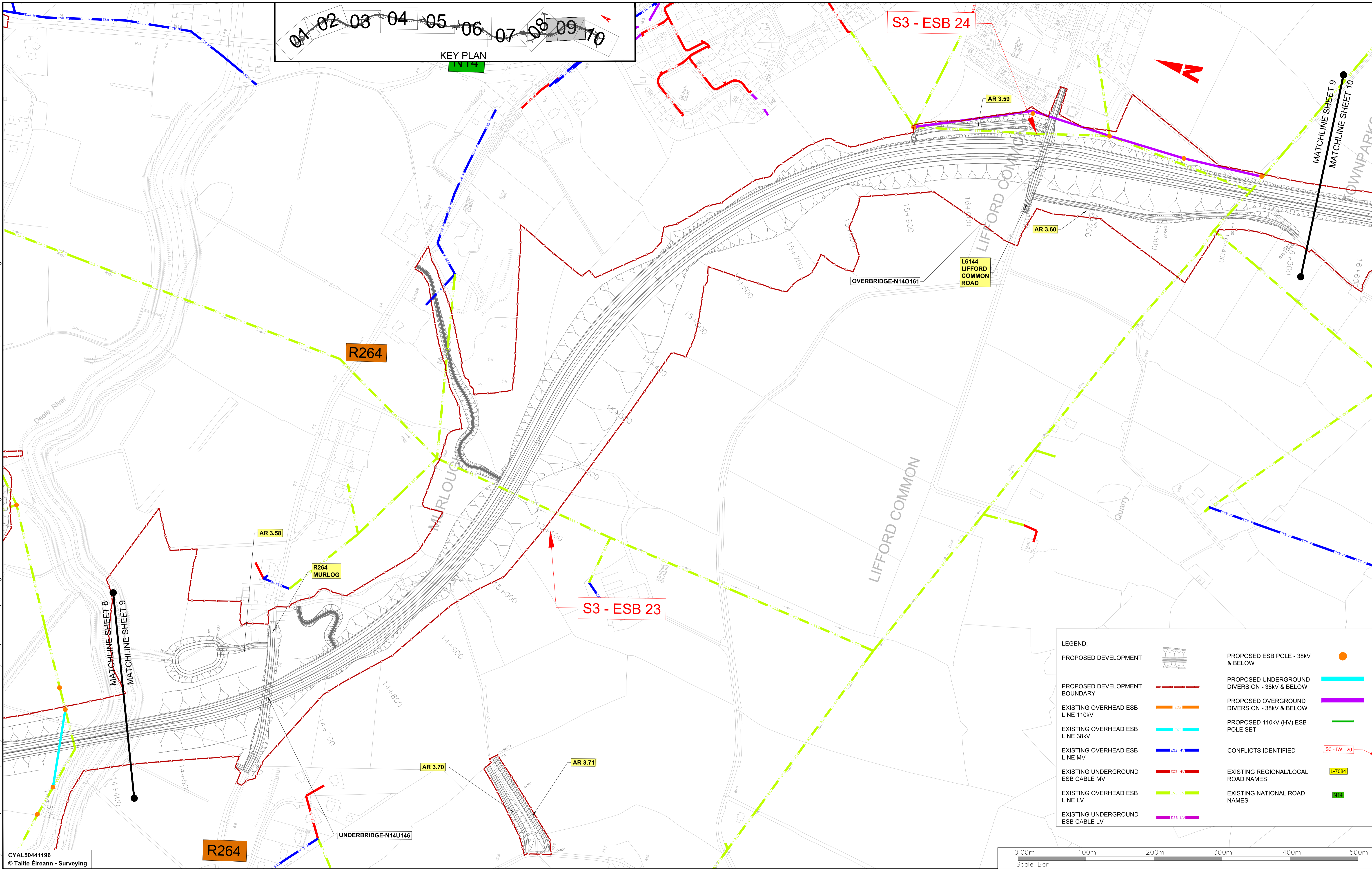
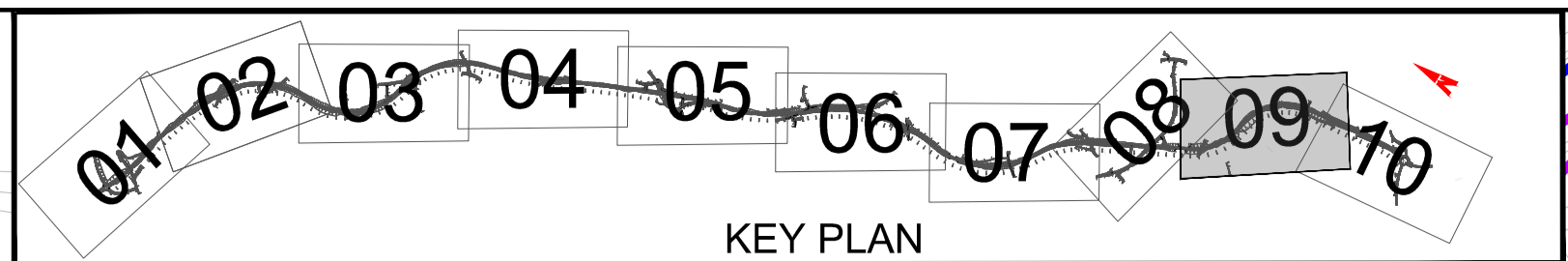

**LEGEND:**

PROPOSED DEVELOPMENT		PROPOSED UNDERGROUND DIVERSION - 38kV & BELOW	
PROPOSED DEVELOPMENT BOUNDARY		PROPOSED OVERGROUND DIVERSION - 38kV & BELOW	
EXISTING OVERHEAD ESB LINE 110kV		PROPOSED 110kV (HV) ESB POLE SET	
EXISTING OVERHEAD ESB LINE 38kV		CONFLICTS IDENTIFIED	
EXISTING OVERHEAD ESB LINE MV		EXISTING REGIONAL/LOCAL ROAD NAMES	
EXISTING UNDERGROUND ESB CABLE MV		EXISTING NATIONAL ROAD NAMES	
EXISTING OVERHEAD ESB LINE LV			
EXISTING UNDERGROUND ESB CABLE LV			

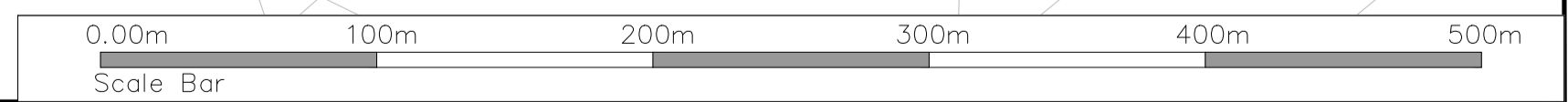

CYAL50441196  
© Taitte Éireann - Surveying



**Notes**  
DO NOT SCALE. Use figured dimensions only. All levels are referred to Ordnance Survey Datum, Mean Head.  
This drawing is the property of Donegal County Council. It is a confidential document and must not be copied, used, or its contents divulged without prior written consent. This document should not be relied on or used in circumstances other than those for which it was originally prepared. Barry Transportation accepts no responsibility for this document to any other party other than the party by whom it was commissioned.

Rev.	Date	Drawn	Description	Chk'd	Appr.
P01	13.11.25	MG	ISSUE FOR PLANNING	JMM	ED

Project Title: TEN-T PRIORITY ROUTE IMPROVEMENT PROJECT DONEGAL Section 3 - N14 Manorcrossingham to Lifford/Strabane/A5 Link		Drawing Title: Proposed Diversion ESB		Status: A3
Designed: JMM	Date: NOV 2025	EAIR Drawing Identifier:		Rev: P01
Drawn: MG	Scale @ A1:1:2500	EAIR Drawing 16.09		
Approved: ED	@ A3:1:5000	File Identifier:	TT_Y16112-BT-1A-HUT-S3-DR-CU-27031	
Checked: JMM	Sheet: 9 OF 10			

Vegis.racine.localbu\_mens\UBS\0 - Projects\Dublin\Projects\Harcrow\Bary\16 Projects\Y16112 - TEN-T Priority Route Improvement Project Donegal\Civil\CAD\WIP\Prelim Design\CIV\DWG\GatTT\_Y16112-BT-1A-HUT-S3-DR-CU-27031\_Proposed\_Diversions\_ESB.dwg

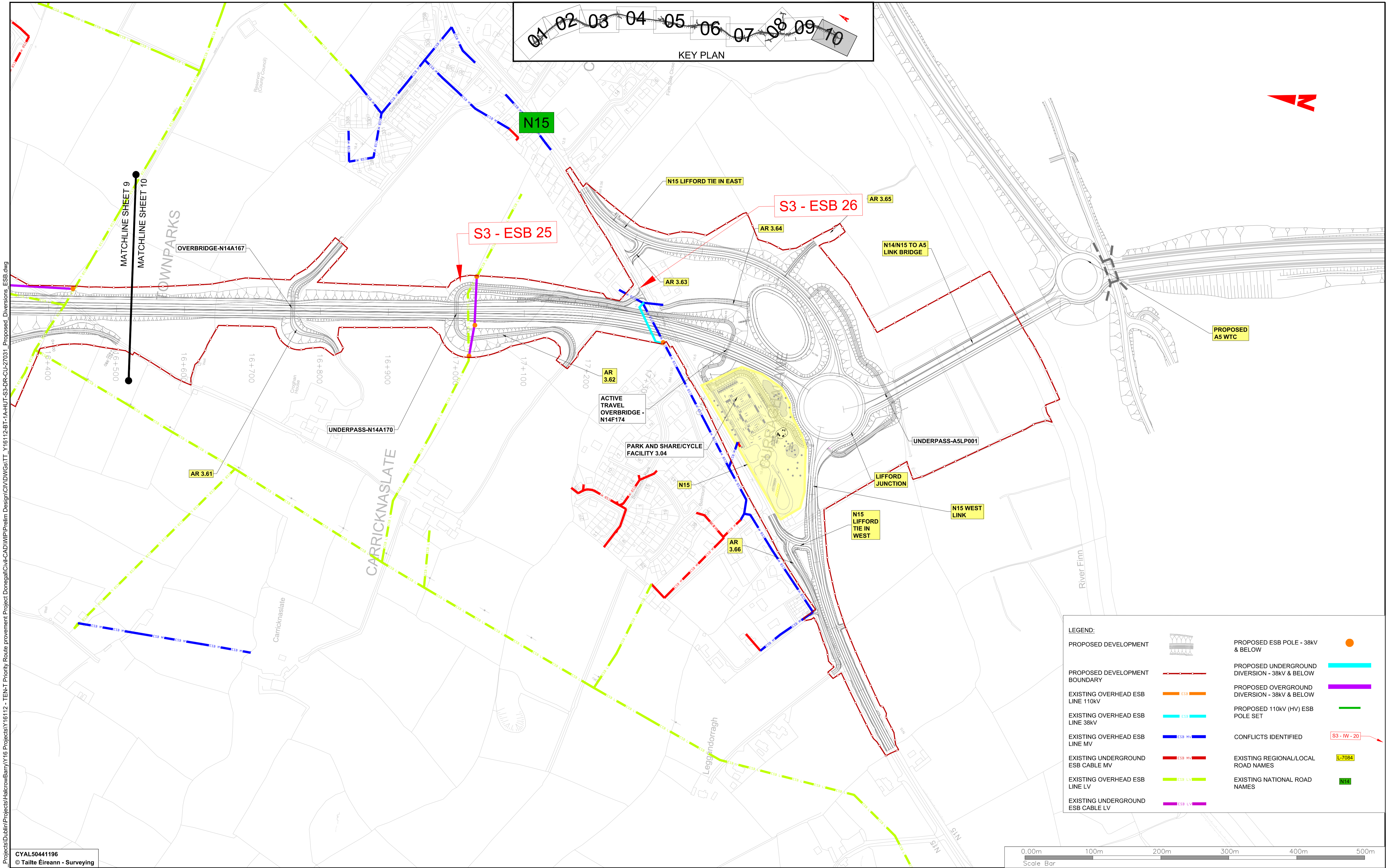
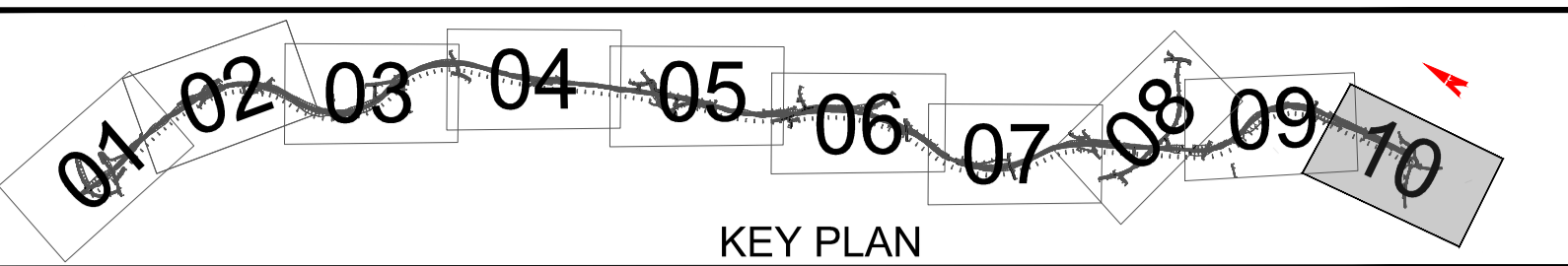

**LEGEND:**

PROPOSED DEVELOPMENT		PROPOSED ESB POLE - 38kV & BELOW	
PROPOSED DEVELOPMENT BOUNDARY		PROPOSED UNDERGROUND DIVERSION - 38kV & BELOW	
EXISTING OVERHEAD ESB LINE 110kV		PROPOSED OVERGROUND DIVERSION - 38kV & BELOW	
EXISTING OVERHEAD ESB LINE 38kV		PROPOSED 110kV (HV) ESB POLE SET	
EXISTING OVERHEAD ESB LINE MV		CONFLICTS IDENTIFIED	
EXISTING UNDERGROUND ESB CABLE MV		EXISTING REGIONAL/LOCAL ROAD NAMES	
EXISTING OVERHEAD ESB LINE LV		EXISTING NATIONAL ROAD NAMES	
EXISTING UNDERGROUND ESB CABLE LV			

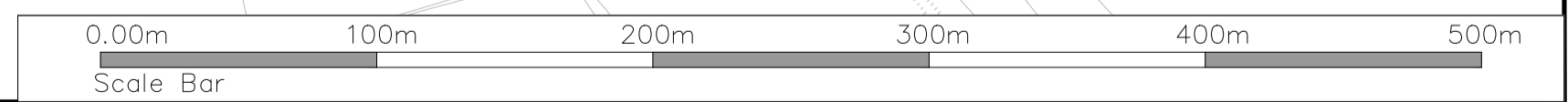

CYAL50441196  
© Taite Éireann - Surveying



**Notes**  
DO NOT SCALE. Use figured dimensions only. All levels are referred to Ordnance Survey Datum, Mean Head.  
This drawing is the property of Donegal County Council. It is a confidential document and must not be copied, used, or its contents divulged without prior written consent. This document should not be relied on or used in circumstances other than those for which it was originally prepared. Barry Transportation accepts no responsibility for this document to any other party other than the party by whom it was commissioned.

Rev.	Date	Drawn	Description	Chk'd	Appr.
P01	13.11.25	MG	ISSUE FOR PLANNING	JMM	ED

Project Title: TEN-T PRIORITY ROUTE IMPROVEMENT PROJECT DONEGAL Section 3 - N14 Manor Cunninghamham to Lifford/Strabane/A5 Link		Drawing Title: Proposed Diversion ESB		Status: A3
Designed: JMM	Date: NOV 2025	EIAR Drawing Identifier: EIAR/Drawing 16.09		Rev: P01
Drawn: MG	Scale @ A1:1:2500 @ A3:1:5000	File Identifier: TT_Y16112-BT-1A-HUT-S3-DR-CU-27031		
Approved: ED	Sheet: 10 OF 10			
Checked: JMM				

Legis.racine.local\ub\0...\_Projects\Dublin\Projects\Halcrow\Barry\16 Projects\Y16112-BT-1A-HUT-S3-DR-CU-27031\_Proposed\_Diversion\_ESB.dwg